

# Poly-Set<sup>®</sup> Anchors

## The Truly Versatile Plug Anchor



PS-0608SP



PS-1012SP



### DESCRIPTION/SUGGESTED SPECIFICATIONS

#### Plug Anchors — SPECIFIED FOR ANCHORAGE INTO ALL BASE MATERIALS



Poly-Set  
Plug  
Anchor

The Poly-Set is a polyethylene expansion anchor designed for fastening into drywall, hollow block, brick and solid concrete.

### ADVANTAGES

- Unique twisting action provides superior holding over standard plug anchors
- Resistant to moisture, chemicals or atmospheric conditions—can be used anywhere
- Pre-packaged in kits with matching screws and carbide-tipped drill bit
- Works well in *all* base materials

### INSTALLATION STEPS

#### For Solid Concrete

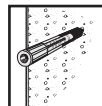

1. Drill hole at least 1/4" deeper than anchor length and insert anchor until flange is flush.



2. Fasten fixture by inserting sheet metal screw through fixture and into anchor.

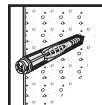

3. Tighten screw.

#### For Hollow Material

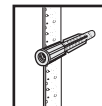

1. Drill hole and insert anchor until flange is flush.

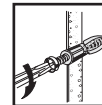

2. Fasten fixture by inserting sheet metal screw through fixture and into anchor.

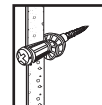

3. Expand anchor after screw head is against fixture, tighten screw the number of additional turns indicated on the chart below.

DRYWALL THICKNESS	PS-0608S	PS-1012S
3/8"	7 - 9 Turns	-----
1/2"	5 - 7 Turns	8 - 9 Turns
5/8"	3 - 4 Turns	6 - 7 Turns
3/4"	1 - 2 Turns	4 - 5 Turns

*Approximate number of additional turns after screw head is against fixture for indicated thickness of hollow wall.*

### SELECTION CHART

#### Poly-Set Anchors

PART NUMBER	DRILL BIT SIZE	ANCHOR LENGTH	SCREW SIZE	GRIP RANGE	QTY/WT PER BOX (lbs.)	QTY/WT PER MASTER CTN (lbs.)
PS-0608SP	3/16	1-1/4"	#6 - 8	3/8 - 3/4"	100/ 0.9	1000/ 2
PS-1012SP	9/32	1-7/16"	#10 - 12	1/2 - 1"	100/ 1.8	1000/ 4

### PERFORMANCE TABLES

#### Average Ultimate Tension Load in Various Base Materials

PART NUMBER	DRYWALL (1/2")	CONCRETE (2000 PSI)	CONCRETE (4000 PSI)	HOLLOW BLOCK (CMU)
PS-0608SP	110 lbs.	225 lbs.	265 lbs.	235 lbs
PS-1012SP	145 lbs.	355 lbs.	390 lbs.	385 lbs

Allowable load values are based upon a 4 to 1 safety factor. Divide by 4 for allowable load values.

#### Poly-Set Kits

PART NUMBER	DRILL BIT SIZE	KIT CONTAINS	GRIP RANGE	QTY/WT PER BOX (lbs.)	QTY/WT PER MASTER CTN (lbs.)
PS-0608SKP	3/16	100 1-1/4" anchors/100 #8 screws	3/8 - 3/4"	1/ 1.0	10/ 11
PS-1012SKP	9/32	50 1-7/16" anchors/50 #12 screws	1/2 - 1"	1/ 1.2	10/ 12