

# E-Z Anchor™

## The Original Self-Drilling Drywall Anchor



### E-Z Anchor Kit

**Starter Kit**  
**Part Number: EZ25**  
**Kit Contains:**  
25 Zinc Anchors  
25 Screws



## DESCRIPTION/SUGGESTED SPECIFICATIONS

### E-Z Anchor Self-Drilling Drywall Anchors— SPECIFIED FOR ANCHORAGE INTO GYPSUM WALLBOARD



**E-Z Anchor  
Self-Drilling  
Anchor**

The E-Z Anchor is a one-piece self-drilling anchor designed for optimal holding performance in gypsum wallboard. Available in zinc or high strength engineered plastic (non-conductive). Ideal anchor for 3/8", 1/2" and 5/8" gypsum wallboard.

## ADVANTAGES

- Fast—no pre-drilling
- Easy—just use #2 phillips bit
- Clean and neat—tri-cut point drills a small hole and seats flush
- Corrosion resistance
- Removable—easily backed out of wallboard
- Breakaway point for easy usage when cavity is shallow

## APPLICATIONS

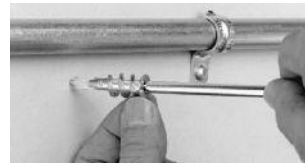

- Electrical fixtures
- HVAC fixtures
- Bathroom accessories
- Shelving
- Closet organizers
- Curtain rods
- Signage

## INSTALLATION STEPS

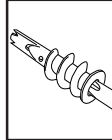

**1.** Place #2 phillips screwdriver or cordless screwdriver (#2 phillips bit) into recess of E-Z Anchor.

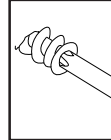

**2.** Press into Gypsum wallboard while turning the anchor clockwise until seated flush.

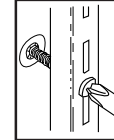

**3.** Place fixture in position over installed E-Z Anchor. Insert screw (#8A or AB screws are recommended). Tighten fixture into place.

## SELECTION CHART

### E-Z Anchor

PART NUMBER	DESCRIPTION	QTY/WT PER BOX lbs.	QTY/WT PER MASTER CARTON lbs.
EZ100	Zinc E-Z Anchor	100/ 1.6	1000/17.0
EZPPL100	Plastic E-Z Anchor	100/ 0.1	1000/ 4.2
EZ25	25 Zinc Anchors/25 Screws (#8 – 1-1/4" sheet metal screw)	1/ 0.9	10/ 10

\* Not for overhead

## PERFORMANCE TABLE

### E-Z Anchor

MAXIMUM FIXTURE THICKNESS	ULTIMATE PULLOUT LBS. GYPSUM BOARD THICKNESS			ULTIMATE SHEAR LBS. GYPSUM BOARD THICKNESS		
	3/8"	1/2"	5/8"	3/8"	1/2"	5/8"
3/4"	40	50	75	135	150	200

Divide by 4 for allowable load values.